

1 log into UA ArcGIS Online

Go to <https://ualabama.maps.arcgis.com/>, click “The University of Alabama”, login by using myBama id and password

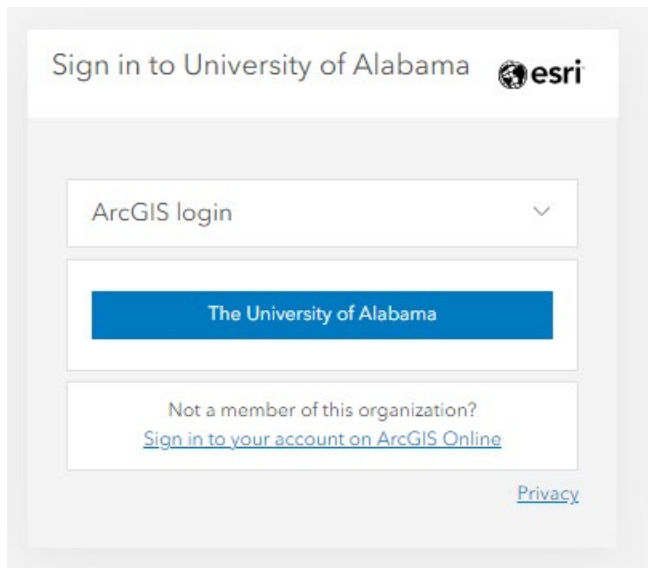

2 download ArcGIS Pro from ArcGIS Online and install

Click the username and “My settings”

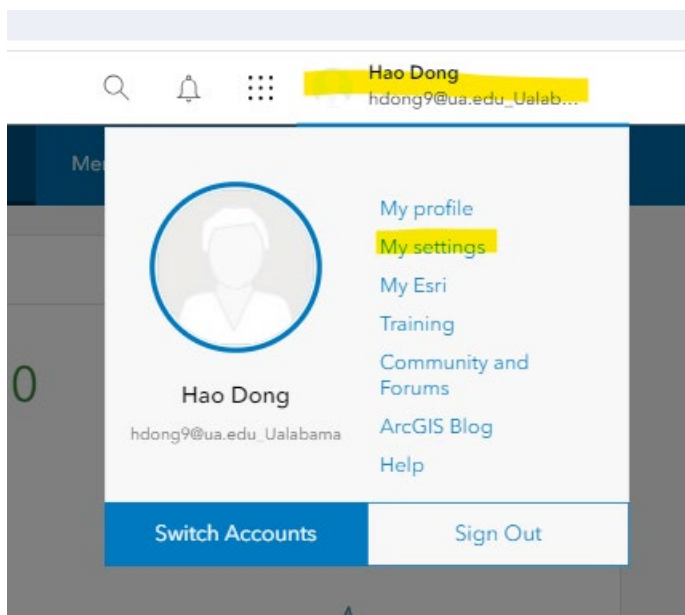

Click “Licenses” and “Download ArcGIS Pro”

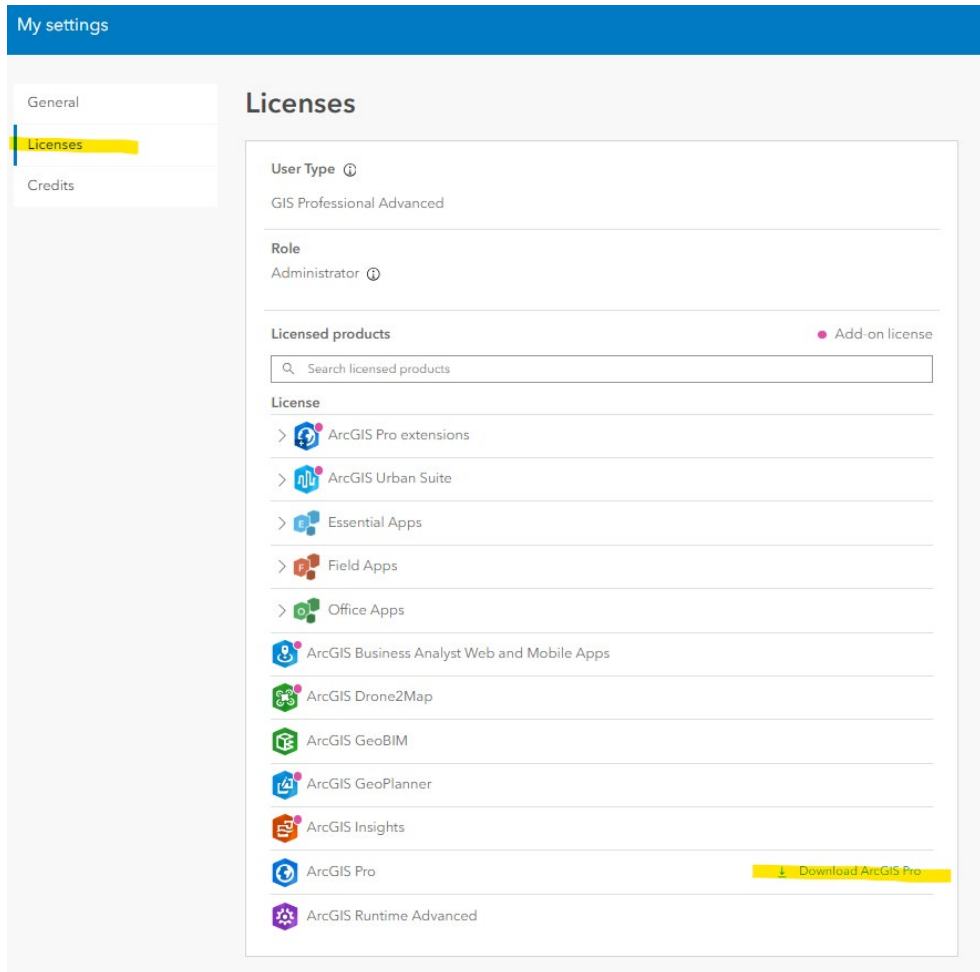

Follow the instruction to install ArcGIS Pro

* .NET 8.0 would be needed if not installed yet, if so, just follow the link, download, and install .NET 8.0 and restart ArcGIS Pro installation

3 license ArcGIS Pro

After running ArcGIS Pro, click “Your ArcGIS organization’s URL”

Enter “ualabama” and then click “Continue”

Then click “The University of Alabama”, login by using myBama id and password

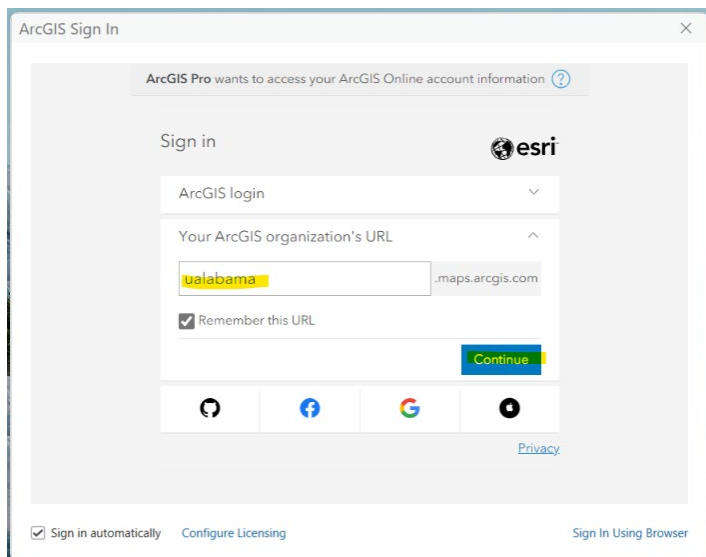
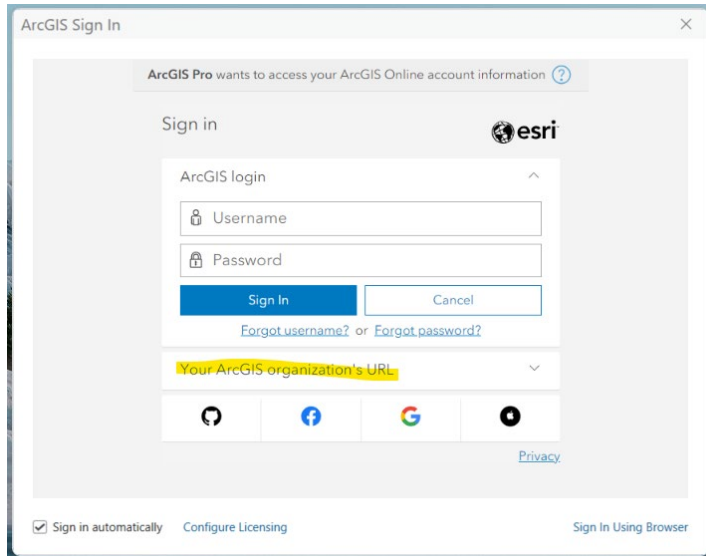

4 check license expiration date

Click “Settings” and “Licensing”

 ArcGIS® Pro

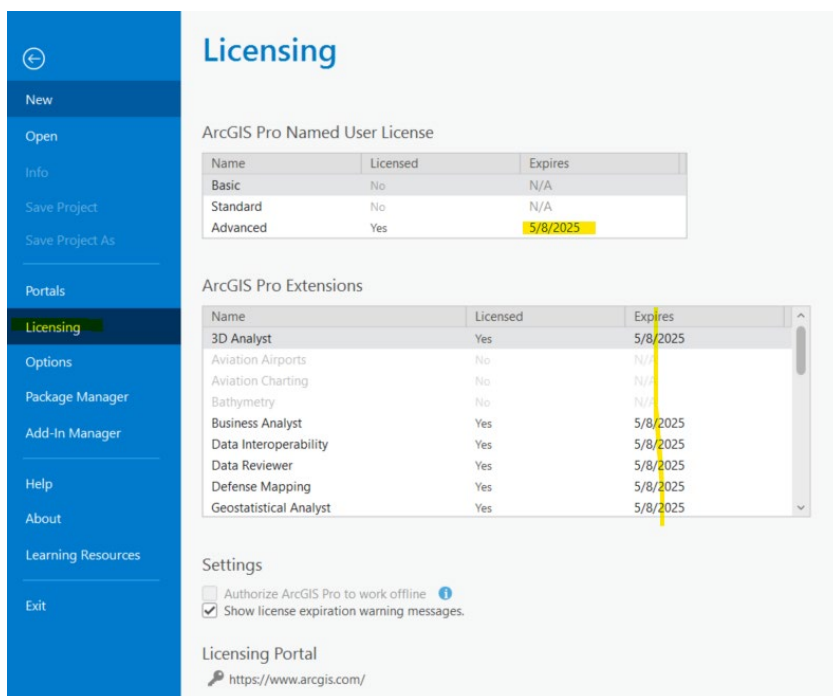
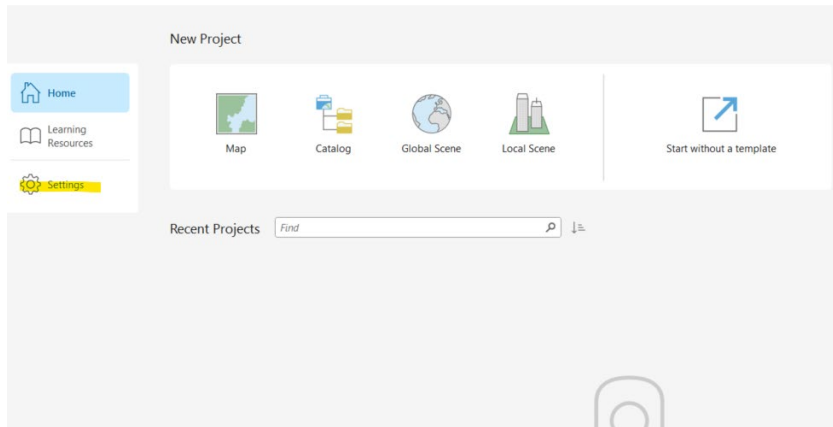

If encountered any issue, please submit an inquiry with IT Service Desk (<https://oit.ua.edu/services/help-and-user-services/>) with details and our GIS support staff will be in touch

Happy Mapping